

- Swirl diffusers
- Circular
- Steel
- White, RAL 9010



Variable manual swirl diffusers type RWR-4

Round adjustable swirl ceiling diffuser for high ceiling (3 to 12 m)

Application

- For air supply in ventilation and air conditioning systems

Material

- Steel and aluminium combination

Colour

- White, RAL 9010

Composition

- Manually adjustable blades with β = blade angle
- Perforated plate in the collar of the diffuser

Text for tender

- The air supply diffusers for high ceilings are of the swirl type with manually adjustable blades. They are made of steel and aluminium with white powder coating finish RAL 9010.
- **ATC Type RWR-4**

Order example

- **RWR-4, 400**

Explanation

RWR-4 = Diffuser type

400 = Neck size of diffuser

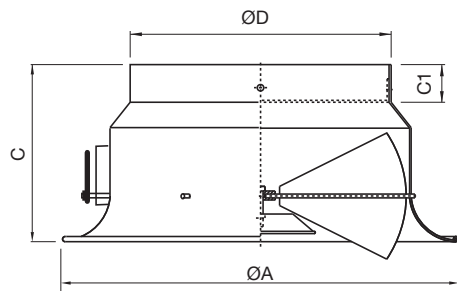

Dimensions

RWR-4	ØD [mm]	ØA [mm]	C [mm]	C1 [mm]
125	125	205	130	40
160	160	250	155	40
200	200	310	174	40
250	250	400	200	40
315	315	480	240	40
400	400	615	265	55
500	500	790	320	60
630	630	940	380	80
800	800	1142	555	75

Quick selection

β=45°		125	160	200	250	315	400	500	630	800
Qv	Aeff	0.01	0.02	0.03	0.05	0.08	0.12	0.20	0.31	0.50
100	veff	2.40	1.30							
	Ps	13	4.50							
	Lth	1.40	1							
	Lw	35	25							
200	veff	4.30	2.60	1.80						
	Ps	40	18	7						
	Lth	2.80	1.70	1.80						
	Lw	50	37	28						
300	veff		4.10	2.60	1.70					
	Ps		37	17	7					
	Lth		2.80	2	1.60					
	Lw		49	37	28					
400	veff			3.50	2.20					
	Ps			28	13					
	Lth			2.80	2					
	Lw			45	35					
500	veff				2.80	1.70				
	Ps				18	8				
	Lth				2.70	2				
	Lw				38	28				
700	veff				4	2.50	1.50			
	Ps				38	18	7			
	Lth				3.60	2.70	2			
	Lw				48	37	28			
1000	veff					3.60	2.20	1.40		
	Ps					29	10	5		
	Lth					4	2.30	1.90		
	Lw					47	33	25		
1500	veff						3.30	2.10		
	Ps						24	12		
	Lth						4.30	2.80		
	Lw						43	33		
2000	veff						4.50	2.80	1.70	
	Ps						40	18	8	
	Lth						5	4.10	3	
	Lw						49	37	29	
3000	veff							3.80	2.70	1.70
	Ps							32	17	7
	Lth							5.60	4.50	3.50
	Lw							47	37	28
5000	veff								4.50	2.70
	Ps								40	18
	Lth								7	5.30
	Lw								50	38
7000	veff									4
	Ps									38
	Lth									7.50
	Lw									48

Symbols and specifications

- Values without Coanda effect
- Temperature difference Dt = -10K
- Lt 0.25 = Throw in m at vt = 0.25m/s
- Ps = Static pressure loss in Pa
- Lw = Acoustic power in dB(A)
- Qv = Air Volume in m³/h
- Blades at β=45° angle